

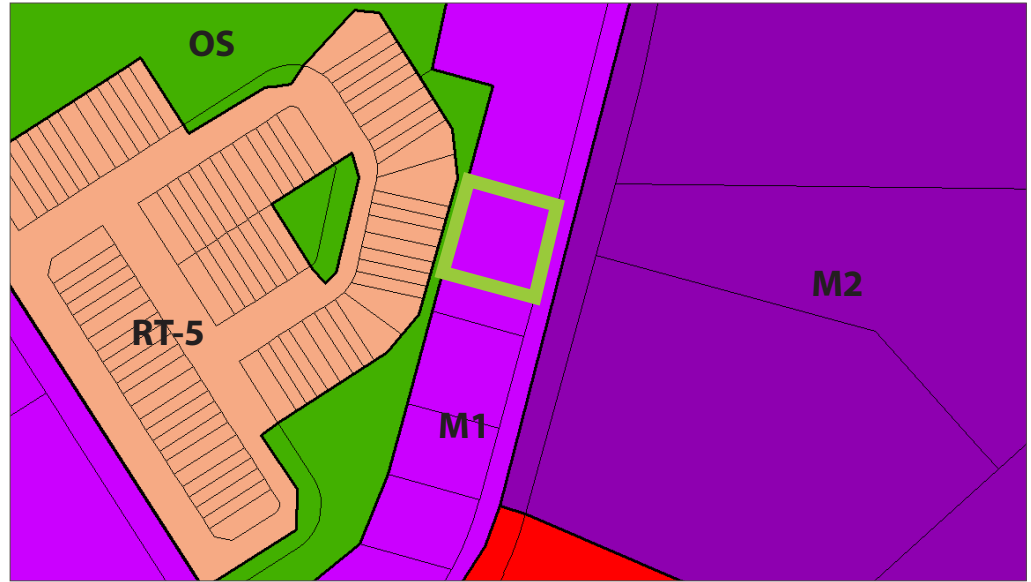

INDUSTRIAL DEVELOPMENT OPPORTUNITY

148 PILLSBURY DRIVE



ZONING: Industrial Zone (M1)

QUICK FACTS:

OFFICIAL PLAN DESIGNATION:

- Employment Area

LAND SIZED:

- Frontage: 45.72 m
- Depth: 44.76 m
- Area: 0.21 ha

PROPERTY STATUS:

- Undeveloped

ASSESSMENT ROLL NUMBER
4374-020-013-05260

PERMITTED USES:

- Adult Entertainment Parlor
- Ambulance Depot
- Animal Hospital
- Attached Accessory Dwelling Unit
- Auction Centre
- Automobile Body Shop
- Automobile Car Wash
- Automobile Gas Bar
- Automobile Sales Agency
- Automobile Service Station
- Banquet Hall
- Catering Establishment
- Child Care Centre
- Commercial Entertainment Establishment
- Commercial School
- Conference Centre
- Contractors Shop
- Data Processing Center
- Eating Establishment
- Enclosed Warehouse and Storage
- Factory Outlet
- Fitness Club
- Laboratory
- Manufacturing Facility
- Marina Dry Land
- Mobile Fast Food Facility
- Multi Occupancy Industrial Building
- Office Uses Accessory to a Permitted Use
- Place of Assembly
- Printing Establishment
- Private Club
- Professional Office
- Public Use
- Radio and Communication Use
- Recreational Vehicle and Vessel
- Sales and Rental Agency
- Rent-all Shop
- Self Storage Units
- Training and Rehabilitation Centre
- Welding and Metal Fabrication Plant

PLANNING AND BUILDING SERVICES

WES CROWN, DIRECTOR

wcrown@midland.ca (705) 526-4275 x2215

ANGELA ZHAO, PLANNER

azhao@midland.ca (705) 526-4275 x2214

TOWN OF MIDLAND

575 Dominion Avenue
Midland, Ontario
L4R 1R2

PHONE (705) 526-4275

FAX (705) 526-9971



148 PILLSBURY DRIVE: SERVICING AND AIR PHOTO

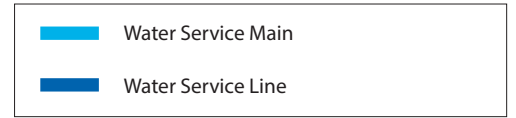
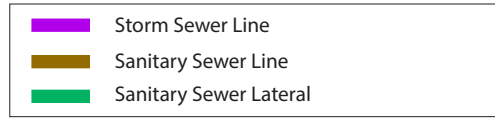
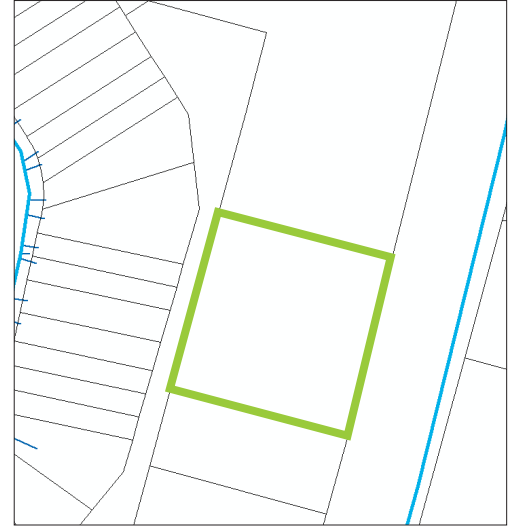
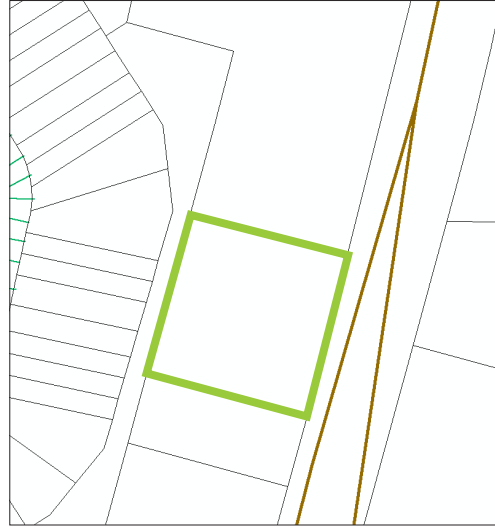

148 PILLSBURY DRIVE: SITE PHOTOS



East view from Pillsbury Drive



View from Pillsbury Drive

PLANNING AND BUILDING SERVICES

WES CROWN, DIRECTOR
wcrown@midland.ca (705) 526-4275 x2215

ANGELA ZHAO, PLANNER
azhao@midland.ca (705) 526-4275 x2214

TOWN OF MIDLAND

575 Dominion Avenue
Midland, Ontario
L4R 1R2

PHONE (705) 526-4275
FAX (705) 526-9971